

PART 1 - MECHANICAL FLOOR PLAN

SCALE: 1/8" = 1'-0"

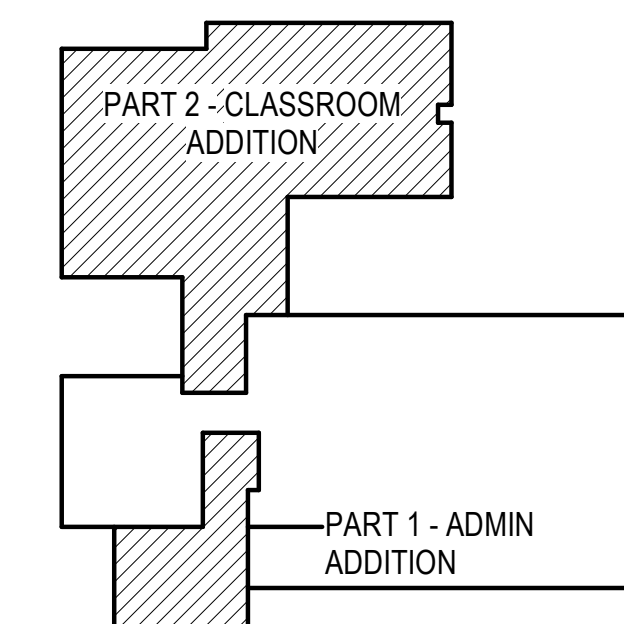

KEY PLAN



PLAN NOTES:

- 1 EXISTING FLOOR GRILLE AND DUCTWORK BELOW FLOOR TO REMAIN. PROTECT DUCTWORK AND FLOOR GRILLE DURING CONSTRUCTION.
- 2 EXISTING CEILING DIFFUSER AND/OR GRILLE TO REMAIN. PROTECT DURING CONSTRUCTION AND MAINTAIN CONNECTION TO EXISTING DUCTWORK.
- 3 EXISTING CEILING GRILLE, EXHAUST FAN AND DUCT UP THRU ROOF TO REMAIN. PROTECT DURING CONSTRUCTION AND MAINTAIN OPERATION.
- 4 EXISTING DUCTWORK ABOVE CEILINGS TO REMAIN. PROTECT DURING CONSTRUCTION. FIELD VERIFY EXACT SIZES AND LOCATIONS. NOT ALL DUCTWORK SHOWN.
- 5 EXISTING 24x48 RETURN AIR GRILLES IN CORRIDOR CEILING TO BE REMOVED, RETAINED AND RE-INSTALLED FOR NEW CEILING WORK. REFER TO ARCHITECTURAL DRAWINGS FOR NEW CEILING BEING INSTALLED IN CORRIDORS. RECONNECT EXISTING GRILLES TO EXISTING DUCTWORK AS REQUIRED.
- 6 EXISTING ROOF MOUNTED EQUIPMENT AND ASSOCIATED DUCTWORK TO REMAIN. PROTECT DURING CONSTRUCTION AND MAINTAIN OPERATION.
- 7 PROVIDE AND INSTALL NEW ROOM SENSOR AS SPECIFIED. CONNECT TO CORRESPONDING EQUIPMENT AND TO EXISTING BUILDING CONTROL SYSTEM. CONTRACTOR TO FIELD VERIFY LOCATION AND TYPE OF EXISTING BUILDING CONTROL SYSTEM.
- 8 EXISTING STEAM CONVECTOR AND/OR UNIT HEATER TO REMAIN. PROTECT DURING CONSTRUCTION AND MAINTAIN CONNECTION TO EXISTING STEAM AND CONDENSATE RETURN PIPING AND TO EXISTING CONTROLS.
- 9 EXISTING FLOOR GRILLE AND DUCTWORK BELOW FLOOR TO REMAIN. REMOVE AND RETAIN GRILLE AS REQUIRED FOR NEW FLOOR WORK BEING DONE. COVER EXISTING DUCT TO KEEP CLEAN DURING CONSTRUCTION. RE-INSTALL EXISTING FLOOR GRILLE AFTER NEW FLOOR HAS BEEN INSTALLED.
- 10 EXISTING WALL MOUNTED THERMOSTAT AND/OR SENSOR TO REMAIN. PROTECT DURING CONSTRUCTION AND MAINTAIN CONNECTION TO EXISTING EQUIPMENT. REMOVE EXISTING CONTROL AS REQUIRED FOR NEW WALL FINISHES AND RE-INSTALL AFTER WORK IS COMPLETE.
- 11 PROVIDE AND INSTALL CEILING MOUNTED EXHAUST FAN AS SPECIFIED. RISE 6" DIA. DUCT UP THRU ROOF WITH ROOF CAP AND BACK-DRAFT DAMPER. REFER TO DETAIL CM3.1 FOR TYPICAL INSTALLATION.
- 12 PROVIDE AND INSTALL NEW GAS FIRED FURNACE AS SPECIFIED COMPLETE WITH DX COOLING COIL. MOUNT EQUIPMENT ON 14" PLENUM BASE WITH EXTERNAL FILTER RACK AT BASE OF FURNACE. REFER TO DETAIL HM3.1 FOR PLENUM BASE CONSTRUCTION AND TO DETAIL EM3.2 FOR TYPICAL FURNACE PIPING CONNECTIONS.
- 13 PROVIDE AND INSTALL NEW CONDENSING UNITS AS SPECIFIED. MOUNT UNITS ON 4" THICK CONCRETE PAD WITH 1" THICK NEOPRENE ISOLATION PADS AT EACH CORNER. REFER TO REFRIGERANT PIPING DIAGRAM LM3.1 FOR TYPICAL PIPING CONNECTIONS.
- 14 RUN 10x6 OUTSIDE AIR DUCT FROM LOUVER AND CONNECT TO RETURN AIR DUCT OR PLENUM. PROVIDE MOTORIZED DAMPER, MANUAL BALANCING DAMPER AND DUCT ACCESS DOOR IN DUCTWORK. REFER TO DETAIL BM3.1 FOR TYPICAL DAMPER INSTALLATION.

ALTERNATE #1:

- A1 DISCONNECT AND REMOVE EXISTING STEAM BOILER. ALL EXISTING HEADER, GAS, AND WATER PIPING ARE TO REMAIN. REPLACE WITH NEW CAST IRON SECTIONAL STEAM BOILER AS SPECIFIED. CONNECT NEW BOILER TO EXISTING HEADER, GAS PIPING AND WATER PIPING. MAKE MODIFICATIONS IN PIPING AS REQUIRED FOR CONNECTION TO NEW BOILER. REFER TO BOILER PIPING DIAGRAM ON SHEET M2.1 FOR TYPICAL PIPING CONNECTIONS.
- A2 EXISTING STEAM HEADER AND ZONE PIPING (AND ZONE VALVES) ARE TO REMAIN. DISCONNECT FROM EXISTING BOILER BEING REMOVED. MAKE ADJUSTMENTS AS REQUIRED TO EXISTING HEADER TO RECONNECT TO NEW STEAM BOILER BEING INSTALLED. CONTRACTOR TO FIELD VERIFY EXISTING CONDITIONS, SIZES AND LOCATIONS OF EXISTING PIPING. MAKE MODIFICATIONS TO EXISTING HEADER AND ZONE PIPING AS REQUIRED TO CONNECT TO NEW BOILER. INSULATE ALL NEW AND EXISTING STEAM PIPING AS SPECIFIED.
- A3 DISCONNECT AND REMOVE EXISTING FLUE ALONG WITH EXISTING BOILER. PROVIDE NEW 12" DIA. FLUE AND CONNECT TO NEW BOILER. EXTEND 12" DIA. FLUE TO EXISTING CHIMNEY AND CONNECT. PROVIDE SHEET METAL SEAL AROUND NEW FLUE TO COVER EXISTING OPENING. SEAL AIR TIGHT WITH FIRE RATED CAULKING.

GENERAL NOTES:

- A- THE CONTRACTOR SHALL CHECK AND VERIFY ALL DIMENSIONS AND CONNECTIONS ON THE JOB SITE. ALL WORK SHALL BE EXECUTED FROM MEASUREMENTS TAKEN AT THE SITE.
- B- THE MECHANICAL CONTRACTOR SHALL BE RESPONSIBLE TO INSURE PROPER CODE CLEARANCES FOR ELECTRICAL AND MECHANICAL ACCESS WHEN INSTALLING ANY EQUIPMENT SUPPLIED BY THE MECHANICAL CONTRACTOR.
- C- IT IS CRITICAL THAT THIS CONTRACTOR COORDINATE EQUIPMENT LOCATIONS WITH PIPING, DUCTWORK, ELECTRICAL CONDUIT AND BUILDING STRUCTURE TO INSURE CODE COMPLIANCE.
- D- CEILING DIFFUSERS ARE SHOWN IN APPROXIMATE LOCATIONS. REFER TO LIGHTING PLANS AND REFLECTED CEILING PLAN FOR EXACT LOCATIONS.
- E- DUCT DIMENSIONS CALLED OUT ON DRAWINGS ARE INSIDE FREE AREA DIMENSIONS. ACOUSTICAL DUCT LINER ARE TO BE ADDED TO OVERALL MEASUREMENTS.
- F- ALL DUCTWORK AND PIPING WHICH PASSES THRU FIRE RATED WALLS TO BE FIRE STOPPED WITH APPROVED FOAM OR SEALANT. REFER TO SPECIFICATIONS FOR APPROVED MANUFACTURERS.

ORIGINAL DRAWING SIGNED BY: DWAYNE C. SUDWEEKS
 DATE ORIGINAL SIGNED: April 12, 2018 ORIGINAL ON FILE AT:
 ENGINEERED SYSTEMS ASSOCIATES 1355 EAST CENTER,
 POCATELLO, IDAHO 83201

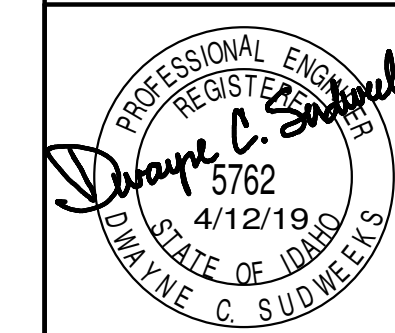

Engineered Systems Associates
 1355 EAST CENTER
 POCATELLO, IDAHO 83201
 PHONE: (208) 233-0501
 FAX: (208) 233-0529
 EMAIL: esa@engsystems.com
 ESA JOB NUMBER: 18072

PROJECT: ADDITION & REMODEL FOR:

HARWOOD ELEMENTARY
 JEFFERSON JOINT SCHOOL DISTRICT NO. 251
 200 W 3RD N, RIGBY, IDAHO 83442

nbw architects p.a.
 ARCHITECTURE / PLANNING / INTERIORS
 SCOTT L NELSON A.I.A. KEVIN R BODILY A.I.A. JAMES H WYATT A.I.A.
 900 IDAHO PARKWAY P.O. BOX 2212 - IDAHO FALLS, IDAHO 83402-2212
 (208) 338-5322 8778 (208) 338-5322 8785 (208) 338-5322 8785 (208) 338-5322 8785

SHEET TITLE: PART 1 - MECHANICAL FLOOR PLAN

REVISIONS

PROJECT NO. 16070

DATE: APRIL 2019

DRAWN BY: M JENSEN

CHECKED BY: D SUDWEEKS

DRAWING NO.:

M1.1